

FIRST LEVEL

**Lloyd Center
Portland, Oregon**

GLIMCHER
DEVELOPMENT CORPORATION
GLIMCHER PROPERTIES LIMITED PARTNERSHIP
180 East Broad Street, 21st Floor
Columbus, OH 43215
Phone: 614.621.9000
Fax: 614.621.9321

Revisions	
No.	Date
1	

GROSS LEASABLE AREA:
Mall Shop GLA:

- Anchors:
- 1) BARNES&NOBLE
 - 2) ICE RINK
 - 3) CINEMAS 8
 - 4) MACYS
 - 5) MARSHALLS
 - 6) NORDSTROM
 - 7) ROSS
 - 8) SEARS
 - 9) APOLLO DENTAL

Out Parcel
Total GLA:

WEB-MLP-FL-10Q3

1" = 40'-0"

07.01.10

1101

All of the tenant names which are indicated on this plan represent those leases which are executed, out for signature, in negotiation or proposed. All tenancies specified may not actually come into existence. All square footages and dimensions are approximate and subject to field verification.

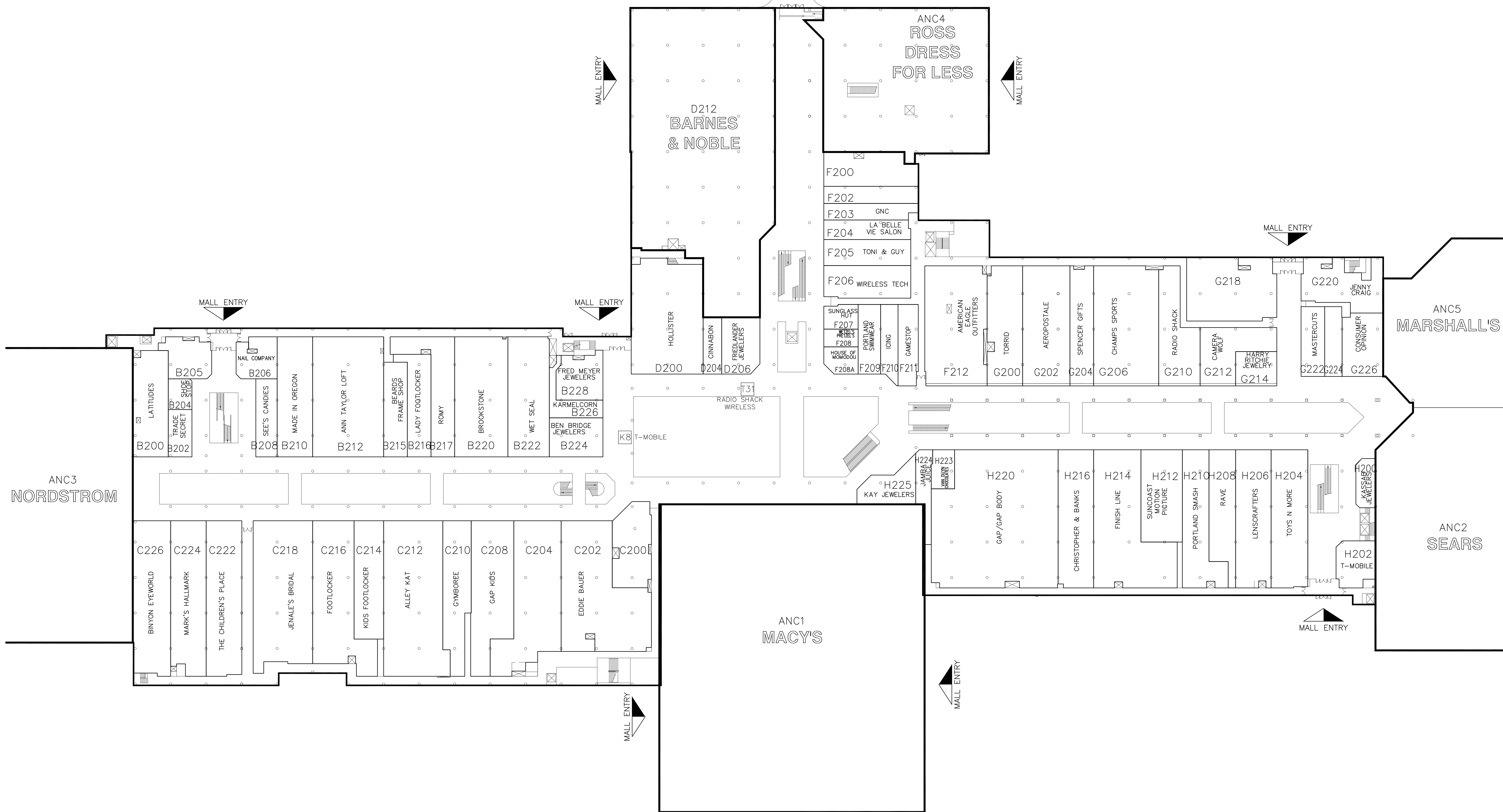

SECOND LEVEL

**Lloyd Center
Portland, Oregon**

GLIMCHER DEVELOPMENT CORPORATION
 GIMCHER PROPERTIES LIMITED PARTNERSHIP
 180 East Broad Street, 21st Floor
 Columbus, OH 43215
 Phone: 614.621.9000
 Fax: 614.621.9321

Revisions	
No.	Date
1	

GROSS LEASABLE AREA:
 Mall Shop GLA:

- Anchors:
- 1) BARNES&NOBLE
 - 2) ICE RINK
 - 3) CINEMAS 8
 - 4) MACY'S
 - 5) MARSHALLS
 - 6) NORDSTROM
 - 7) ROSS
 - 8) SEARS
 - 9) APOLLO DENTAL

Out Parcel
 Total GLA:

WEB-MLP-SL-10Q3
 1" = 40'-0"

07.01.10

All of the tenant names which are indicated on this plan represent those leases which are executed, out for signature, in negotiation or proposed. All tenancies specified may not actually come into existence. All square footages and dimensions are approximate and subject to field verification.

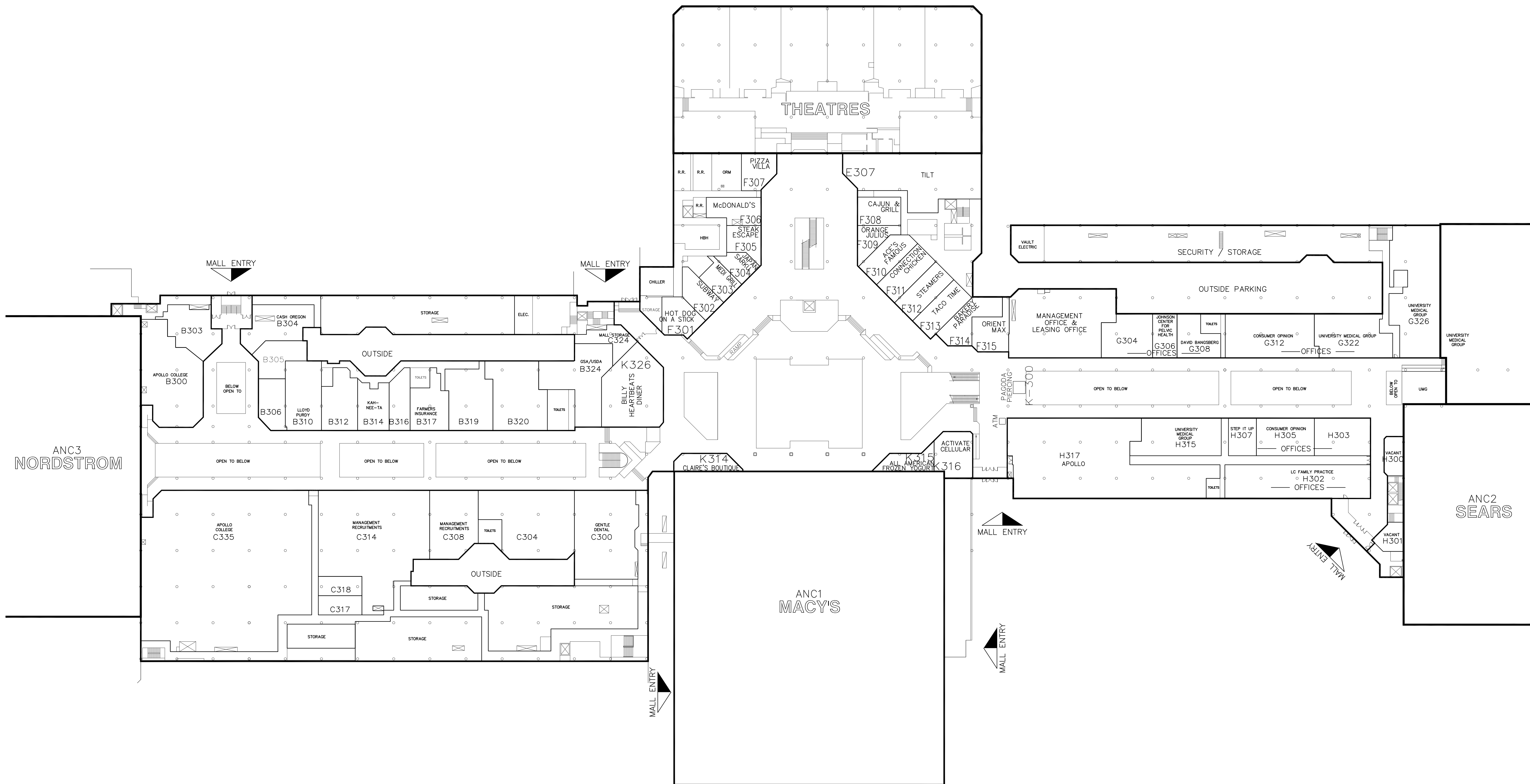

THEATER/FOOD COURT/OFFICE LEVEL

**Lloyd Center
Portland, Oregon**

GLIMCHER
DEVELOPMENT CORPORATION
GLIMCHER PROPERTIES LIMITED PARTNERSHIP
180 East Broad Street, 21st Floor
Columbus, OH 43215
Phone: 614.621.9000
Fax: 614.621.9321

Revisions	
No.	Date
1	

GROSS LEASABLE AREA: _____
Mall Shop GLA: _____

- Anchor:
- 1) BARNES&NOBLE
 - 2) ICE RINK
 - 3) CINEMAS 8
 - 4) MACYS
 - 5) MARSHALLS
 - 6) NORDSTROM
 - 7) ROSS
 - 8) SEARS
 - 9) APOLLO DENTAL

Out Parcel
Total GLA: _____

WEB-MLP-TL-10Q3
1" = 40'-0"

07.01.10

All of the tenant names which are indicated on this plan represent those leases which are executed, out for signature, in negotiation or proposed. All tenancies specified may not actually come into existence. All square footages and dimensions are approximate and subject to field verification.

