

**LOWER LEVEL**

**Jersey Gardens**  
Elizabeth, New Jersey

**GLIMCHER**  
DEVELOPMENT CORPORATION  
GLIMCHER PROPERTIES LIMITED PARTNERSHIP  
180 East Broad Street, 21st Floor  
Columbus, OH 43215  
Phone: 614.621.9000  
Fax: 614.621.9321

Revisions	
No.	Date
1	

GROSS LEASABLE AREA:  
Mall Shop GLA:

- Anchor:
- 1) BED BATH BEYOND
  - 2) BURLINGTON
  - 3) COHOES FASHION
  - 4) DAFFY'S
  - 5) FILENE'S
  - 6) GAP OUTLET
  - 7) GROUP USA
  - 8) JEEPERS!
  - 9) LAST CALL
  - 10) LOEWS THEATRES
  - 11) MARSHALLS
  - 12) MODELL'S
  - 13) NIKE FACTORY
  - 14) OFF 5TH SAKS
  - 15) OLD NAVY

Out Parcel  
Total GLA:

**WEB-MLP-LL-10Q3**  
1" = 50'-0"

07.01.10  
1101

All of the tenant names which are indicated on this plan represent those leases which are executed, out for signature, in negotiation or proposed. All tenancies specified may not actually come into existence. All square footages and dimensions are approximate and subject to field verification.

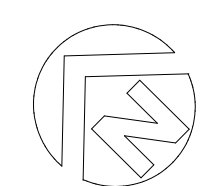

# Jersey Gardens

## Elizabeth, New Jersey

**GLIMCHER**  
DEVELOPMENT CORPORATION

GLIMCHER PROPERTIES LIMITED PARTNERSHIP  
180 East Broad Street, 21st Floor  
Columbus, OH 43215  
Phone: 614.621.9000  
Fax: 614.621.9321

Revisions	
No.	Date
1	

GROSS LEASABLE AREA:  
Mall Shop GLA:

- Anchors:
- 1) BED BATH BEYOND
  - 2) BURLINGTON
  - 3) COHOES FASHION
  - 4) DAFFY'S
  - 5) FILENE'S
  - 6) GAP OUTLET
  - 7) GROUP USA
  - 8) JEEPERS!
  - 9) LAST CALL
  - 10) LOEWS THEATRES
  - 11) MARSHALLS
  - 12) MODELL'S
  - 13) NIKE FACTORY
  - 14) OFF 5TH SAKS
  - 15) OLD NAVY

Out Parcel  
Total GLA:

**WEB-MLP-UL-10Q3**  
1" = 50'-0"

07.01.10  
1101

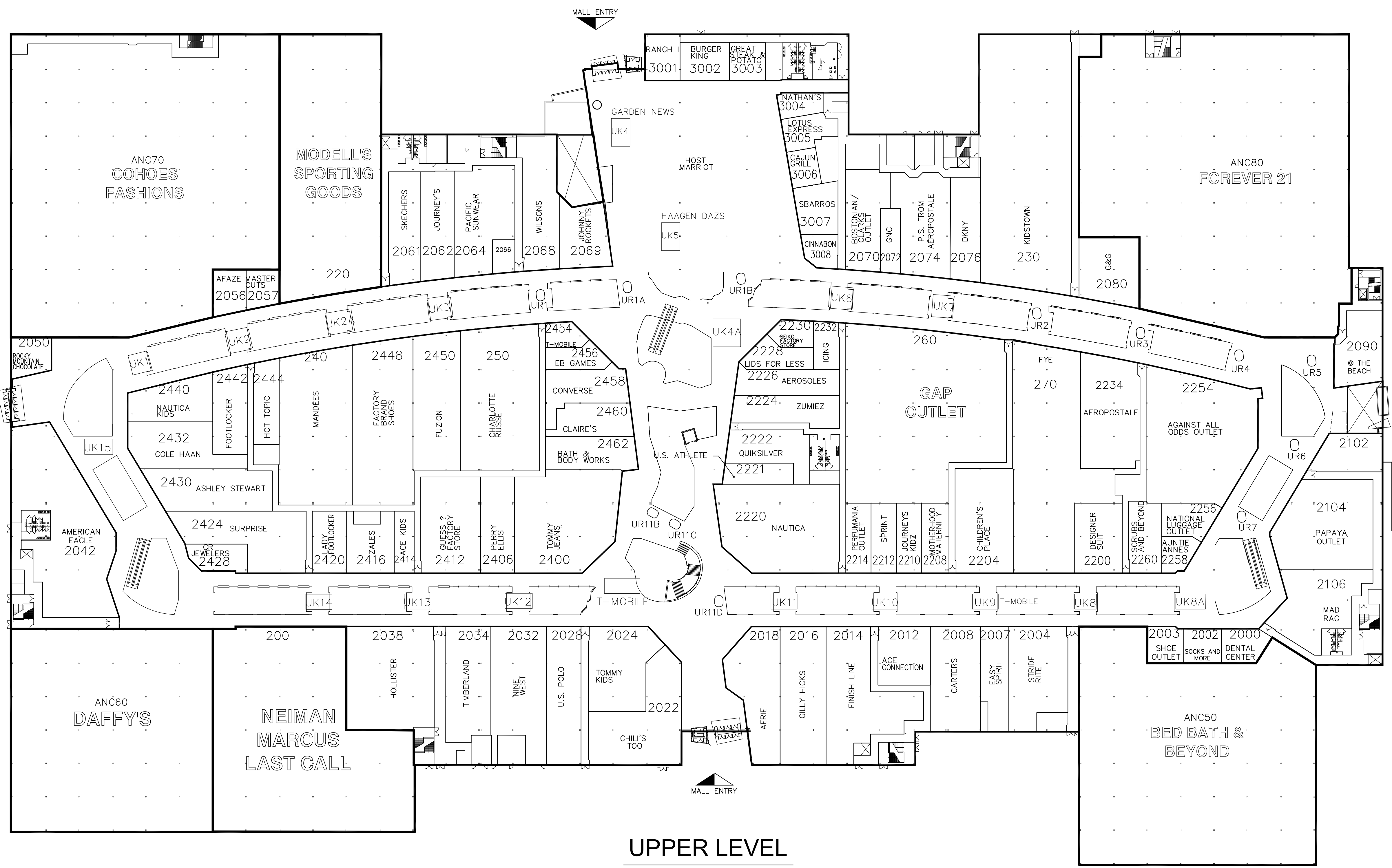

### UPPER LEVEL

All of the tenant names which are indicated on this plan represent those leases which are executed, out for signature, in negotiation or proposed. All tenancies specified may not actually come into existence. All square footages and dimensions are approximate and subject to field verification.

